

Schäffer

2020 - 2345

Low style loaders:
2024 SLT - 2345 SLT

COMPACT LOADERS

Big on performance, compact in size



SCHÄFFER

For over 60 years, we have been developing loaders to meet individual requirements. Customer satisfaction has made us what we are today: one of the most capable and successful suppliers of farm loaders, wheel loaders and telescopic wheel loaders ever. Every day our employees create new, customised solutions.

Every Schäffer loader is the result of years of experience and innovative thinking. Our products set the standard in terms of the highest possible reliability and durability. You can rely on Schäffer for lower costs throughout the whole operating life, and for performance, safety and driving comfort for many years to come.

THE SCHÄFFER COMPACT CLASS: SMALL BUT MIGHTY

The compact class is one of the most successful series ever built by Schäffer. Specially developed for use in confined spaces, but with no compromise on reliability and ergonomics. In line with all other Schäffer models, you can expect excellent safety and low operating costs from

our compact class machines. They have proved successful for use in indoor operations, on small and medium-sized farms as well as on horse ranches. A wide range of equipment and attachments make the machines extremely versatile.

The compact class:



2020 15 kW (20 HP)



2024 19 kW (26 HP)



2028 19 kW (26 HP)



2032 22 kW (30 HP)



2034 24 kW (33 HP)
26 kW (36 HP)



2336 26 kW (36 HP)



2345 33 kW (45 HP)



2024 SLT 19 kW (26 HP)



2028 SLT 19 kW (26 HP)



2030 SLT 22 kW (30 HP)



2336 SLT 26 kW (36 HP)



2345 SLT 33 kW (45 HP)

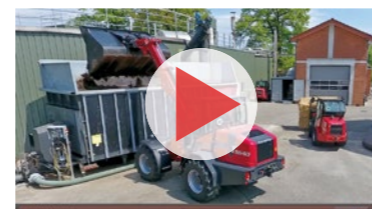

Schäffer loaders in action:
www.schaeffer.de/en/videos





Schaffer headstock SWH

With the Schaffer headstock SWH, coupling of any attachment is a breeze. Hydraulic lock is standard. Genuine Schaffer attachments are also equipped with the double hook frame so that roll back and dump angle are easy to adjust. This pays dividends with materials such as grain, where a larger roll back angle is preferable, as well as other materials such as soil. Simple, flexible, ingenious engineering from Schaffer.



Hydraulic drive, foot pedal control

With the hydraulic four-wheel-drive foot pedal controls, the 2020 and 2024 loaders can be operated very easily. The diesel engine revs are adjusted through the accelerator. The direction of travel and speed are controlled with a pedal on the left side of the machine. This outstanding ease of operation makes the machine very manoeuvrable, and is a huge advantage in areas with a lot of changes of speed and direction.

SCHÄFFER 2020 AND 2024: SIMPLE, EFFICIENT AND GOOD VALUE FOR MONEY

When it comes to small spaces, these loaders excel. With an overall width of just 79 cm, the Schaffer 2020 will fit through almost any door. At 89cm wide, its big brother, the Schaffer 2024, is only marginally wider.

These compact dimensions mean that manual work can be mechanised in buildings that were previously inaccessible, making work faster, easier and more productive.

Both machines look similar – the differences are found in the transmission systems. Thanks to their simple technology, the 2020 and 2024 models offer the most affordable entry into the Schaffer world, yet you can be confident of the same high quality as all Schaffer loaders. They retain their value over years with high residual values on the second-hand market.

THE SCHÄFFER 2028: COMPACT PERFORMANCE MACHINE WITH AUTOMOTIVE CONTROL

The Schaffer 2028 is up there with the best of its class when it comes to traction force and agility.

The Kubota diesel engine, hydrostatic drive and the original Schaffer axles give high traction force, while automotive controls automatically adjust the speed of the engine. The

traction force has increased from previous models due to the use of the latest drive components. It's simply not possible to stall the engine - it always works within the optimal range of speeds. The Schaffer 2028: it moves more than you would expect!

THE NEW 2032: PURE DRIVING PLEASURE

The new Schäffer 2032 is one of the most agile and manoeuvrable in its class, and is packed with smart features for efficient and economic use with no compromise on performance.

Firstly, there's a new drive concept – the high-pressure axial piston pump. It is able to convert the output from the powerful 22 kW/ 30 HP Kubota motor into agility which is unrivalled in its class. You'll notice this is the extremely lively operation and rapid acceleration to 20 km/h.

The 2032 also has a very small turning radius, due to the use of axle motors in place of a cardan shaft. Thanks to the high-pressure drive, a high level of thrust can be achieved even without a cardan shaft. This is supported by the new 5-hole axles, which further increase the efficiency due to their adapted transmission ratio and thereby reduce the fuel consumption.

The high working pressure means the drive needs less oil and the working hydraulic system can be reduced. All of which leads to an increase in efficiency, better fuel economy and a decrease in operating costs. The downstream axial piston motor is designed for a maximum speed of 3,700 rotations per minute, but is operated at just 800 rotations per minute. This comparatively low demand guarantees a long service life.



The motor room opens forwards. This makes all service points easily accessible from both sides of the machine.



The ergonomics of this loader are exceptional. The driver has a lot of room despite the very compact dimensions of this machine, and can work comfortably thanks to the optimised position of the joystick and steering wheel.

SCHÄFFER 2032



THE SCHÄFFER 2034: THE LOADER IN THE 2T CLASS



The Schaffer 2034 is an agile loader with an exceptional 3-cylinder Kubota motor with 24 kW (33 HP). An even more powerful motor with 26 kW (36 HP) is available as an option. The 1700 rpm torque in the 2034 is increased by 15% in this higher-powered variant, which means the 2034 can be driven at lower speeds.

The Schaffer axles constructed especially for this loader type guarantee the greatest amount of pushing power. The power of the hydrostatic drive has been calculated to minimise the consumption of diesel fuel. Our low-maintenance and low-wear multidisc brakes are standard features of this series. They run through an oil bath and still deliver their best braking performance. As with all Schaffer loaders, the pivoting articulation is completely maintenance-free.

THE 2300 SERIES: CUSTOMIZED LOADERS, UP TO 20 KM/H

The 2300 series is hard to beat when it comes to equipment variants. Schaffer offers customised loaders. Regardless of the options chosen, Schaffer quality is built in. Our maintenance-free pendulum/articulation point is now even stronger, so machines handle significant tipping loads with ease.

working hydraulics. The powerful four-wheel traction drive is fun, and the new 4-cylinder motors run smoothly. Independent benchmark tests confirm the high level of Schaffer quality again and again.

And when it comes to comfort, Schaffer loaders are at top of their class. The driver has more space and perfectly designed

THE 2300 SERIES OF SCHÄFFER: ADVANTAGES AT A GLANCE





HTF: MAXIMUM THRUST, EVEN IN HIGH GEAR

HTF, or 'High Traction Force', automatically regulates the thrust so the loader can supply the highest possible thrust even in a high gear. HTF uses a new axial piston-bent axis motor that regulates speed automatically depending on the traction. This is particularly useful in an uphill position as the driver does not have to switch to first gear.

HTF comes into its own when digging into aggregate material - if more thrust is required, the hydraulic motor adapts automatically, without the driver having to interfere manually. This means most of the work can be done in fast gear, increasing driving comfort and speeding up work. The Schaffer 2336 and 2345 are equipped and delivered with the HTF-drive as standard.

Benefits:

- Very high thrust forces
- No need to manually shift down a gear when going uphill
- Even at high speed the maximum thrust is always available, e.g. when driving in muck heaps
- Enhanced driving comfort, faster working

TECHNICAL DATA

	2020	2024	2028	2032
Engine	3 Cyl. Kubota. 15 kW (20 HP)	3 Cyl. Kubota. 19 kW (26 HP)	3 Cyl. Kubota. 19 kW (26 HP)	3 Cyl. Kubota. 22 kW (30 HP)
Traction hydraulics	Hydraulic		Hydrostatic-automotive	
Tyres	7.00 - 12 AS Option I 27x8.50 - 15 SKD Option II 27x10.5 - 15 SKD	7.00 - 12 AS Option I 27x8.50 - 15 SKD Option II 27x10.5 - 15 SKD Option III 26x12.00 - 12	7.00 - 12 AS Option I 27x8.50 - 15 SKD Option II 27x10.5 - 15 SKD Option III 26x12.00 - 12	10.0/75 - 15.3 AS Option I 31x15.5 - 15 Option II 30x11.5 - 14.5
Service braking system	Mechanical drum brake		Hydrostatic mechanical drum brake	
Parking brake	Mechanical drum brake			
Working hydraulics Output/pressure	Delivery rate: 31 l/min Operating pressure: 180 bar	Delivery rate: 33 l/min Operating pressure: 200 bar	Delivery rate: from 33 l/min Operating pressure: 200 bar	Delivery rate: from 33 l/min Operating pressure: 200 bar
Steering	Fully hydraulic articulated-swivel steering			
Operating weight	1,400 kg	1,700 kg	1,760 kg	1,850 kg
Lifting capacity	1,200 kg	1,400 kg	1,500 kg	1,600 kg
Tipping load, straight ¹ pallet fork bucket	605 - 749 kg 728 - 871 kg	622 - 786 kg 829 - 973 kg	675 - 841 kg 832 - 976 kg	789 - 941 kg 1,041 - 1,191 kg
Tipping load, articulated ¹ pallet fork bucket	265 kg 350 kg	320 kg 410 kg	375 kg 505 kg	465 kg 580 kg
Payload Pallet fork, even ground ² Pallet fork, uneven ground ² Bucket ³	212 kg 159 kg 175 kg	256 kg 192 kg 205 kg	300 kg 225 kg 252.5 kg	372 kg 279 kg 290 kg
Axles	Original Schäffer axles, 4 wheel nut rim	Original Schäffer axles, 4 wheel nut rim	Original Schäffer axles, 5 wheel nut rim	Original Schäffer axles, 5 wheel nut rim
Speed	0 - 12 km/h	0 - 12 km/h	0 - 15 km/h	0 - 20 km/h
Electric system	Operating voltage: 12 V			
Fill quantities	Fuel: 18 l Hydraulic oil: 26 l	Fuel: 23 l Hydraulic oil: 30 l	Fuel: 23 l Hydraulic oil: 30 l	Fuel: 23 l Hydraulic oil: 30 l
Sound pressure level LpA	84 dB(A)	84 dB(A)	83 dB(A)	84 dB(A)
Sound power level guaranteed LwA equivalent LwA	101 db(A) 98 db(A)	101 db(A) 98 db(A)	101 db(A) 98 db(A)	101 db(A) 98 db(A)
Hand/arm vibration ⁴	< 2.5 m/s ²	< 2.5 m/s ²	< 2.5 m/s ²	< 2.5 m/s ²
Total body vibration ⁴	< 0.5 m/s ²	< 0.5 m/s ²	< 0.5 m/s ²	< 0.5 m/s ²
	-	-	-	-

¹acc. to ISO 8313 ²acc. to EN 474-3 ³acc. to ISO 14397-1 ⁴acc. to ISO 8041 X = as standard

Tyre dimensions and additional equipment can change the operating weight, tipping load and payload.

	2034	2336	2345
Engine	3 Cyl. Kubota, 24 kW (33 HP) Option: 26 kW (36 HP)	4 Cyl. Kubota, 26 kW (36 HP)	4 Cyl. Kubota Turbo, 33 kW (45 HP)
Traction hydraulics	Hydrostatic-automotive		Hydrostatic-automotive, HTF
Tyres	10.0/75 - 15.3 AS Option I 27x10.5 - 15 SKD Option II 31x15.5 - 15	10.0/75 - 15.3 AS Option I 27x10.5 - 15 SKD Option II 31x15.5 - 15	10.0/75 - 15.3 AS Option I 27x10.5 - 15 SKD Option II 31x15.5 - 15
Service braking system	Hydrostatic and multi-disc		
Parking brake	Multi-disc brake running in oil bath		
Working hydraulics Output/pressure	Delivery rate: from 40 l/min Operating pressure: 200 bar	Delivery rate: from 42 l/min Operating pressure: 200 bar	Delivery rate: from 42 l/min Operating pressure: 200 bar
Steering	Fully hydraulic articulated-swivel steering		
Operating weight	2,100 kg / 2,300 kg with cabine	2,300 kg / 2,500 kg with cabine	2,350 kg / 2,550 kg with cabine
Lifting capacity	1,600 kg	1,700 kg	1,700 kg
Tipping load, straight ¹ pallet fork bucket	895 - 1,124 kg 1,110 - 1,381 kg	1,048 - 1,321 kg 1,250 - 1,578 kg	1,048 - 1,321 kg 1,250 - 1,578 kg
Tipping load, articulated ¹ pallet fork bucket	605 kg 795 kg	660 kg 960 kg	660 kg 960 kg
Payload Pallet fork, even ground ² Pallet fork, uneven ground ² Bucket ³	484 kg 363 kg 398 kg	528 kg 396 kg 480 kg	528 kg 396 kg 480 kg
Axles	Original Schäffer axles, 5 wheel nut rim; Option: automatic limited-slip differential	Original Schäffer axles, 6 wheel nut rim; Option: automatic limited-slip differential	Original Schäffer axles, 6 wheel nut rim; Option: automatic limited-slip differential
Speed	0 - 15 km/h Option: 0 - 20 km/h	0 - 20 km/h in 2 gear switchable under load	0 - 20 km/h in 2 gear switchable under load, Option: 0 - 28 km/h
Electric system	Operating voltage: 12 V		
Fill quantities	Fuel: 40 l Hydraulic oil: 30 l	Fuel: 40 l Hydraulic oil: 30 l	Fuel: 40 l Hydraulic oil: 30 l
Sound pressure level LpA	85 dB(A)	84 dB(A)	84 dB(A)
Sound power level guaranteed LwA equivalent LwA	101 db(A) 101 db(A)	101 db(A) 99/98 db(A)	101 db(A) 99/98 db(A)
Hand/arm vibration ⁴	< 2.5 m/s ²	< 2.5 m/s ²	< 2.5 m/s ²
Total body vibration ⁴	< 0.5 m/s ²	< 0.5 m/s ²	< 0.5 m/s ²
	-	X	X

¹acc. to ISO 8313 ²acc. to EN 474-3 ³acc. to ISO 14397-1 ⁴acc. to ISO 8041 X = as standard

Tyre dimensions and additional equipment can change the operating weight, tipping load and payload.

DIMENSIONS

		2020	2024	2028	2032
A	Wheelbase [mm]	1,375	1,375	1,375	1,445
B	Chassis length [mm]	2,600	2,780	2,780	2,850
C	Overall length with standard bucket [mm]	3,330	3,530	3,530	3,550
D	Digging depth [mm]	110	110	110	110
E	Reach [mm]	3,180	3,460 / 3,720*	3,460 / 3,720*	3,590 / 3,850*
F	Max, bucket pivot point, [mm]	2,470	2,800 / 3,060*	2,800 / 3,060*	2,880 / 3,110*
G	Loading height with pallet forks [mm]	2,335	2,560 / 2,920*	2,560 / 2,920*	2,750 / 2,980*
H	Max, dumping height [mm]	1,710	1,965 / 2,265*	1,965 / 2,265*	2,170 / 2,400*
I	Front end height [mm]	1,540	1,600 / 1,725*	1,600 / 1,725*	1,680 / 1,805*
J	Dumping width [mm]	580	440	440	560
K	Seat height [mm]	1,020	1,055	1,055	1,160
L	Protective roof height [mm] Cab height [mm]	2,070 -	ab 2,090 -	ab 2,090 -	2,200 -
N	Overall width [mm]	790 - 1,000	890 - 1,240	890 - 1,240	1,050 - 1,260
O	Inner turning radius [mm]	530	660	660	780
P	Outer turning radius [mm]	1,515	1,560	1,560	1,900
Q	Outer radius with standard bucket [mm]	1,800	1,950	1,950	2,350

* Option: high lift

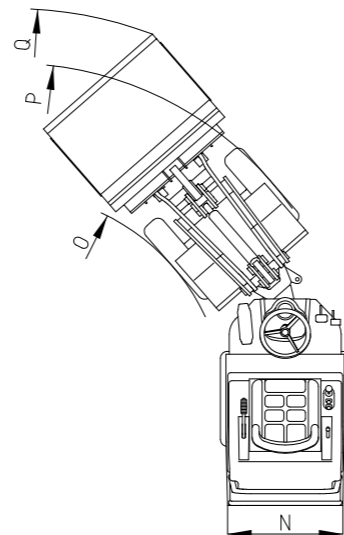
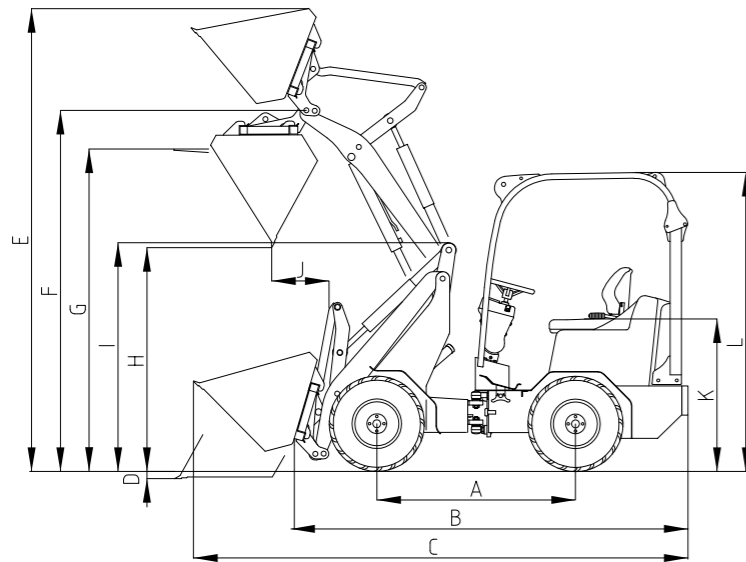

		2034	2336	2345
A	Wheelbase [mm]	1,440	1,550	1,550
B	Chassis length [mm]	2,920	3,230	3,230
C	Overall length with standard bucket [mm]	3,665	3,880	3,880
D	Digging depth [mm]	110	90	90
E	Reach [mm]	3,565 / 3,795*	3,570 / 3,800*	3,570 / 3,800*
F	Max, bucket pivot point, [mm]	2,880 / 3,110*	2,880 / 3,110*	2,880 / 3,110*
G	Loading height with pallet forks [mm]	2,675 / 3,005*	2,680 / 3,100*	2,680 / 3,100*
H	Max, dumping height [mm]	2,090 / 2,345*	2,045 / 2,300*	2,045 / 2,300*
I	Front end height [mm]	1,675 / 1,775*	1,690 / 1,790*	1,690 / 1,790*
J	Dumping width [mm]	590	470	470
K	Seat height [mm]	1,160	1,160	1,160
L	Protective roof height [mm] Cab height [mm]	2,180 2,150	2,215 2,110	2,215 2,110
N	Overall width [mm]	1,020 - 1,290	1,020 - 1,570	1,020 - 1,570
O	Inner turning radius [mm]	1,020	1,125	1,125
P	Outer turning radius [mm]	2,040	2,145	2,145
Q	Outer radius with standard bucket [mm]	2,400	2,500	2,500

* Option: high lift

All technical specifications in this brochure refer to serial models and describe their standard functions. The equipment components and their functions as well as the accessories depend on the individual model and the product options and also on the country and customer specific requirements (the maximum values for tipping loads and payloads can only be reached with additional ballasting). Images may contain products or equipment components which are not mentioned or cannot be obtained as a standard. The descriptions, measurements, images, weight specifications and technical data correspond to the state of the art at the time of printing and are non-binding. We reserve changes in the field of construction, equipment, optics and technology without prior notice, due to the continuous development of the products. In case of doubts concerning the performance or the mode of operation of our products due to special circumstances, we recommend the execution of work samples under controlled conditions. We cannot exclude deviations from images or measurements, calculation errors, printing errors or incompleteness in the prospectus despite all due care. We do therefore not accept any liability for the correctness and completeness of the specifications in this prospectus. We do guarantee the proper functioning of our products within the scope of our General Terms and Conditions. Any guarantees that go beyond these are on principle not provided. Any liability beyond the ones set out in our General Terms and Conditions is excluded.

SCHÄFFER 2024 SLT, 2028 SLT AND 2030 SLT – LOW HEIGHT, FULL POWER

If you need a small loader for jobs in hard to reach areas then check out our SLT loaders – specially designed for use in narrow passageways and restricted head room. The 2030 SLT with a height of 1.89 m and a minimum width of 89 cm is one of the most compact loaders you will find on the market. The 1.8 t loader is a real power pack and ideal for use in indoor areas and in narrow operating conditions. With a tipping load of 920 kg it also moves heavy silage bales safely. Some rival brands require removal of the protective roof in order to access low areas, but with Schäffer's SLT options, there's never a need to compromise on safety.

The 22 kW (30 HP) 2030 SLT is equipped with a hydrostatic drive and provides the typical Schäffer high thrust. The 2028 SLT offers the same chassis as the 2030 SLT and with a 19 kW (26 HP) Kubota diesel engine is still very strong. The 2024 SLT also has this option, but with a simple hydraulic drive – ideal for those customers looking for a new Schäffer at a lower price.



The front and rear bonnet are easy to open, making maintenance to carry out.

SCHÄFFER SLT

SCHÄFFER SLT





The SLT machines of the 23 series are also available with a cab, and still with a machine height of only 1.95 m (depending on tyres).



Getting on and off the machine is very easy (additional step as an option).



The slightly twisted joystick position simplifies operation.



SLTs: LESS THAN 2M TALL

The 2336 is just 1.95 m tall (depending on wheels), and is the ideal machine for working in most height-restricted areas. Compared to the standard 2336, the diesel engine is placed slightly further back and the wheelbase lengthened, creating room for the lower seating position, which makes getting on and off the loader even easier.

The ergonomics are similar to the standard model, and even tall drivers have more than enough space. Another advantage of the longer wheelbase is an increased tipping load – up to 1250kg. Ground clearance matches that of the standard 2336. The SLT protective roof meets the ROPS and FOPS test standard guidelines.

The Schaeffer 2336 SLT is a very agile loader, equipped with a smooth-running 4-cylinder Kubota engine with 26 kW. Alternatively, a more powerful version with 33 kW (2345 SLT) is available. The maximum speed of the 2336 SLT is 15 km/h. An under load switchable fast gear (20 km/h) is available as an option.

TECHNICAL DATA

DIMENSIONS

SCHÄFFER SLT

	2024 SLT	2028 SLT	2030 SLT	2336 SLT	2345 SLT
Engine	3 Cyl. Kubota 19 kW (26 HP)	3 Cyl. Kubota 19 kW (26 HP)	3 Cyl. Kubota 22 kW (30 HP)	4 Cyl. Kubota 26 kW (36 HP)	4 Cyl. Kubota Turbo 33 kW (45 HP)
Traction hydraulics	Hydraulic	Hydrostatic-automotive			
Tyres	7.00-12 AS Option I 27x8.50-15 SKD Option II 27x10.5-15 SKD Option III 26x12.00-12	7.00-12 AS Option I 27x8.50-15 SKD Option II 27x10.5-15 SKD Option III 26x12.00-12	7.00-12 AS Option I 27x8.50-15 SKD Option II 27x10.5-15 SKD Option III 26x12.00-12	10.0/75 - 15.3 AS Option I 27x10.5-15 SKD Option II 31x15.5-15	10.0/75 - 15.3 AS Option I 27x10.5-15 SKD Option II 31x15.5-15
Service braking system	Mechanical drum brake	Hydrostatic mechanical drum brake		Hydrostatic and multi-disc	
Parking brake	Mechanical drum brake		Multi-disc brake running in oil bath		
Working hydraulics Output/pressure	Delivery rate: 33 l/min Operating pressure: 200 bar	Delivery rate: from 33 l/min Operating pressure: 200 bar	Delivery rate: from 33 l/min Operating pressure: 200 bar	Delivery rate: from 42 l/min Operating pressure: 200 bar	Delivery rate: from 42 l/min Operating pressure: 200 bar
Steering	Fully hydraulic articulated-swivel steering				
Operating weight	1,750 kg	1,800 kg	1,850 kg	2,350 kg / 2,425 kg mit Kabine	2,380 kg / 2,445 kg mit Kabine
Lifting capacity	1,400 kg	1,500 kg	1,500 kg	1,700 kg	1,700 kg
Tipping load, straight ¹ pallet fork bucket	787 - 939 kg 1,037 - 1,187 kg	787 - 939 kg 1,037 - 1,187 kg	789 - 941 kg 1,041 - 1,191 kg	1,048 - 1,321 kg 1,395 - 1,717 kg	1,048 - 1,321 kg 1,395 - 1,717 kg
Tipping load, articulated ¹ pallet fork bucket	430 kg 620 kg	430 kg 620 kg	375 kg 505 kg	550 kg 715 kg	550 kg 715 kg
Payload Pallet fork, even ground ² Pallet fork, uneven ground ² Bucket ³	344 kg 258 kg 310 kg	344 kg 258 kg 310 kg	300 kg 225 kg 252.5 kg	440 kg 330 kg 357.5 kg	440 kg 330 kg 357.5 kg
Axles	Original Schäffer axles, 4 wheel nut rim	Original Schäffer axles, 5 wheel nut rim	Original Schäffer axles, 5 wheel nut rim	Original Schäffer axles, 6 wheel nut rim; Option: automatic limited-slip differential	Original Schäffer axles, 6 wheel nut rim; Option: automatic limited-slip differential
Speed	0 - 12 km/h	0 - 15 km/h	0 - 15 km/h	0 - 15 km/h Option: 0 - 20 km/h	0 - 15 km/h Option: 0 - 20 km/h
Electric system	Operating voltage: 12 V				
Fill quantities	Fuel: 23 l Hydraulic oil: 30 l	Fuel: 23 l Hydraulic oil: 30 l	Fuel: 23 l Hydraulic oil: 30 l	Fuel: 40 l Hydraulic oil: 30 l	Fuel: 40 l Hydraulic oil: 30 l
Sound pressure level LpA	83 dB(A)	83 dB(A)	84 dB(A)	83 dB(A)	83 dB(A)
Sound power level guaranteed LwA equivalent LwA	101 db(A) 98 db(A)	101 db(A) 98 db(A)	101 db(A) 98 db(A)	101 db(A) 99/98 db(A)	101 db(A) 99/98 db(A)
Hand/arm vibration ⁴	< 2.5 m/s ²	< 2.5 m/s ²	< 2.5 m/s ²	< 2.5 m/s ²	< 2.5 m/s ²
Total body vibration ⁴	< 0.5 m/s ²	< 0.5 m/s ²	< 0.5 m/s ²	< 0.5 m/s ²	< 0.5 m/s ²

¹ acc. to ISO 8313 ² acc. to EN 474-3 ³ acc. to ISO 14397-1 ⁴ acc. to ISO 8041

Tyre dimensions and additional equipment can change the operating weight, tipping load and payload.

SCHÄFFER SLT

	2024 SLT	2028 SLT	2030 SLT	2336 SLT	2345 SLT	
A	Wheelbase [mm]	1,640	1,640	1,640	1,650	1,650
B	Chassis length [mm]	3,160	3,160	3,160	3,230	3,230
C	Overall length with standard bucket [mm]	3,630	3,630	3,630	4,025	4,025
D	Digging depth [mm]	110	110	110	90	90
E	Reach [mm]	3,460	3,460	3,460	3,570	3,800
F	Max, bucket pivot point, [mm]	2,800	2,800	2,800	2,880	2,880
G	Loading height with pallet forks [mm]	2,600	2,600	2,600	2,680	3,100
H	Max, dumping height [mm]	1,965	1,965	1,965	2,045	2,045
I	Front end height [mm]	1,600	1,600	1,600	1,690	1,790
J	Dumping width [mm]	440	440	440	470	470
K	Seat height [mm]	910	910	910	995	995
L	Protective roof height [mm] Cab height [mm]	from 1,890 from 1,890	from 1,890 from 1,890	from 1,890 from 1,890	from 1,950 from 1,950	from 1,950 from 1,950
N	Overall width [mm]	890 - 1,240	890 - 1,240	890 - 1,240	1,020 - 1,570	1,020 - 1,570
O	Inner turning radius [mm]	760	760	760	870	870
P	Outer turning radius [mm]	1,850	1,850	1,850	1,890	1,890
Q	Outer radius with standard bucket [mm]	2,270	2,270	2,270	2,320	2,320

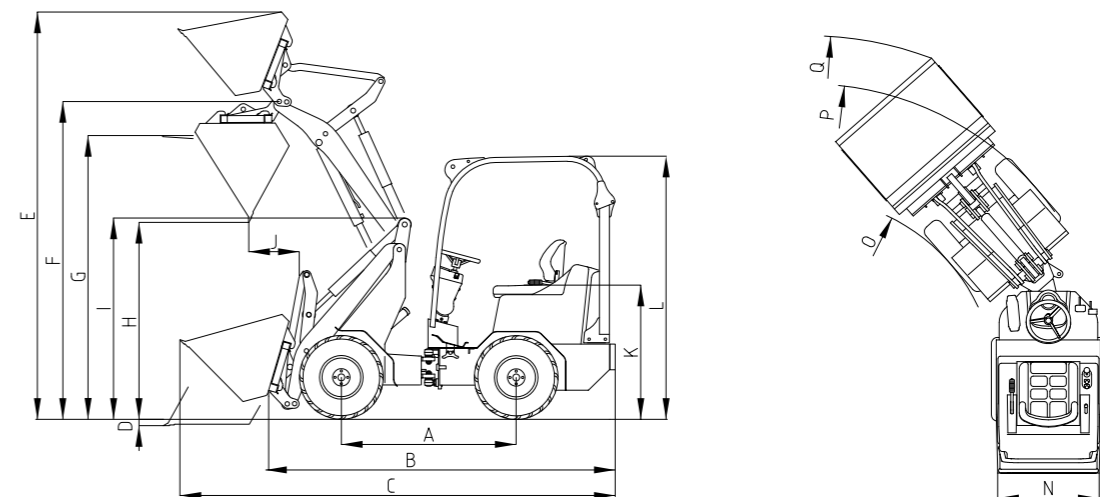

All technical specifications in this brochure refer to serial models and describe their standard functions. The equipment components and their functions as well as the accessories depend on the individual model and the product options and also on the country and customer specific requirements (the maximum values for tipping loads and payloads can only be reached with additional ballasting). Images may contain products or equipment components which are not mentioned or cannot be obtained as a standard. The descriptions, measurements, images, weight specifications and technical data correspond to the state of the art at the time of printing and are non-binding. We reserve changes in the field of construction, equipment, optics and technology without prior notice, due to the continuous development of the products. In case of doubts concerning the performance or the mode of operation of our products due to special circumstances, we recommend the execution of work samples under controlled conditions. We cannot exclude deviations from images or measurements, calculation errors, printing errors or incompleteness in the prospectus despite all due care. We do therefore not accept any liability for the correctness and completeness of the specifications in this prospectus. We do guarantee the proper functioning of our products within the scope of our General Terms and Conditions. Any guarantees that go beyond these are on principle not provided. Any liability beyond the ones set out in our General Terms and Conditions is excluded.

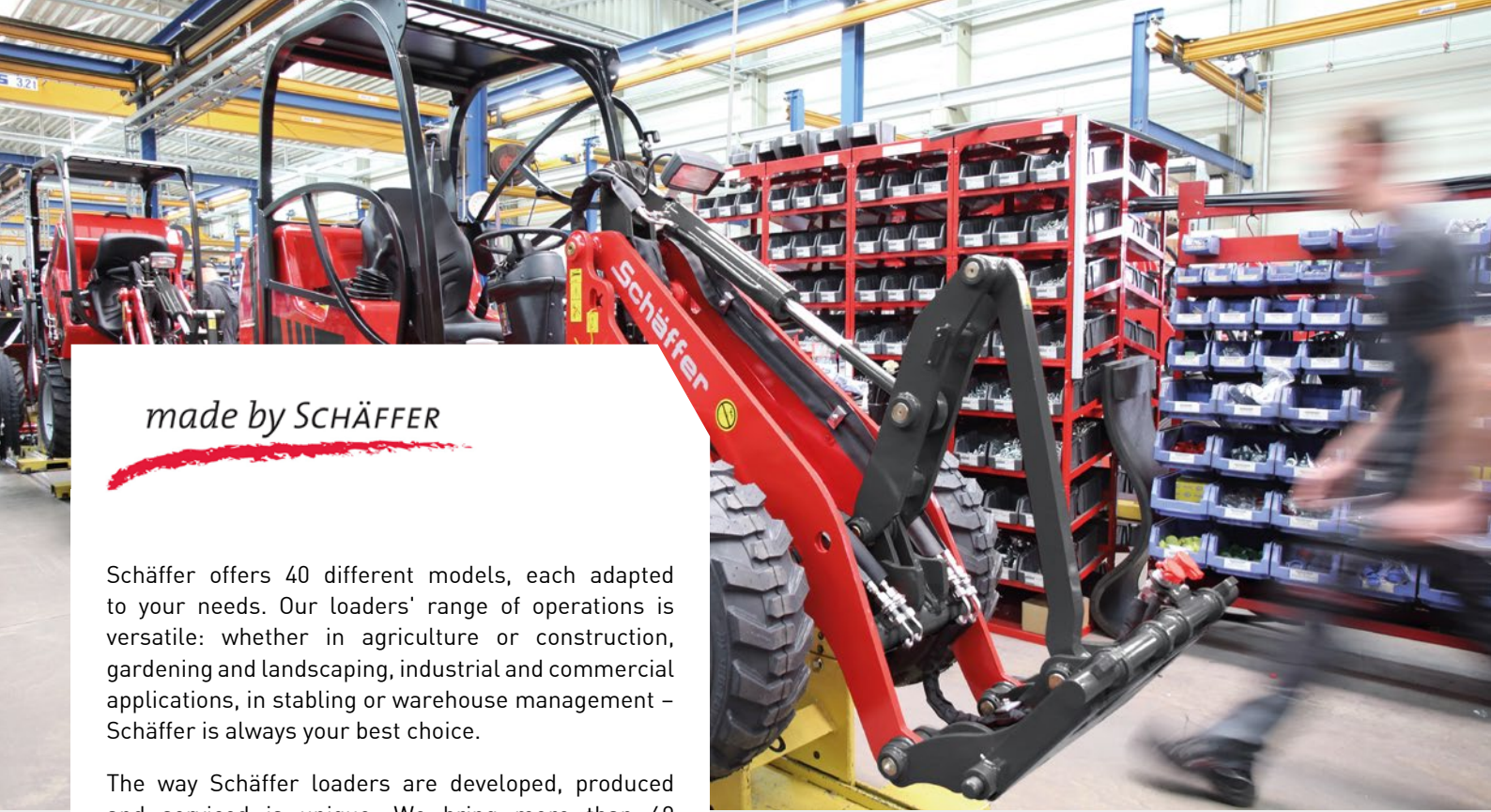

made by **SCHÄFFER**

Schäffer offers 40 different models, each adapted to your needs. Our loaders' range of operations is versatile: whether in agriculture or construction, gardening and landscaping, industrial and commercial applications, in stabling or warehouse management – Schäffer is always your best choice.

The way Schäffer loaders are developed, produced and serviced is unique. We bring more than 60 years' experience, and we always put the end-user first, working to make your job safer, more comfortable and more profitable. Additionally, at our Erwitte location in Germany we use state-of-the-art development and production technologies. Ultimately, it is our employees who continuously develop new solutions, in close contact with the end user. Years of company service together with an enduring spirit form the basis for the special competence and for our global success.

The Schäffer name does not just mean unique product quality. It also stands for safety and the optimal service that we guarantee in Germany, Europe and around the globe.

Purchasing a Schäffer loader is the beginning of a long-term relationship. Your machine will only remain a 100% genuine Schäffer if you use original replacement parts. Only then will it guarantee the reliability you need, and have the right to expect. We offer you and our service partners a 24 hour delivery service – 7 days a week, 365 days a year.



YOUR DEALER:

Schäffer

Schäffer Maschinenfabrik GmbH
Postfach 10 67 | D-59591 Erwitte
fon +49 (0)2943 9709-0
fax +49 (0)2943 9709-50
info@schaeffer.de



WWW.SCHAEFFER.DE/EN

